

Project Boundary Line Traverse		
From - To	Bearing	Distance
0-1	S 21°30' E	141'
1-2	N 59°00' E	405'
2-3	S 23°00' E	305'
3-4	S 89°30' W	553'
5-6	S 33°00' E	80'
6-7	N 88°30' E	963'
7-8	S 44°00' W	440'
8-9	N 76°15' W	707'
9-10	S 74°00' W	15'
11-12	S 23°00' E	9'
12-13	S 00°00' E	267'
13-14	S 63°00' W	4'
15-16	N 70°00' E	359'
16-17	N 06°30' W	240'
17-18	N 87°00' E	310'
18-19	N 15°00' W	390'
19-20	S 67°00' E	450'
20-21	N 47°30' E	520'
21-22	S 15°30' W	450'
22-23	N 71°00' E	415'
23-24	S 38°36' W	1229'
24-25	N 73°00' E	910'
25-26	N 35°00' E	460'
26-27	S 41°00' E	250'
27-28	N 40°00' E	265'
28-29	S 58°00' E	400'
29-30	N 45°30' E	210'
30-31	N 10°15' W	285'
31-32	N 49°00' E	430'
32-33	S 80°00' W	420'
33-34	N 05°00' E	120'
34-35	N 66°00' E	160'
35-36	N 25°00' E	160'
36-37	N 62°30' W	110'
37-38	N 39°00' E	605'
38-39	N 07°10' W	155'
39-40	N 89°00' W	508'
40-41	N 42°20' E	730'
41-42	S 19°50' W	355'
42-43	S 87°35' E	427'
43-44	S 16°35' W	592'
44-45	N 74°50' E	620'
45-46	S 07°50' W	460'
46-47	S 45°45' E	595'
47-48	S 66°30' W	390'
48-49	S 38°20' E	490'
49-50	S 40°22' W	183'
50-51	N 61°00' W	592'
51-52	S 77°15' W	185'
52-53	S 05°10' E	816'
53-54	S 55°30' W	212'
54-55	N 44°45' W	635'
55-56	N 71°00' W	290'
56-57	S 03°30' E	360'
57-58	S 70°00' W	365'
58-59	S 06°00' W	457'
59-60	S 25°00' E	275'
60-61	S 02°40' E	95'
61-62	S 56°30' W	220'
62-63	N 31°00' W	270'
63-64	S 20°00' W	240'
64-65	S 46°00' W	185'
65-66	N 79°30' W	450'
66-67	S 08°30' E	590'
67-68	N 88°30' W	480'
68-69	S 45°15' W	1012'
69-70	S 15°00' E	510'
70-71	S 64°00' W	358'
72-73	N 03°00' W	221'
73-74	S 69°30' E	410'
74-75	S 51°38' E	124'

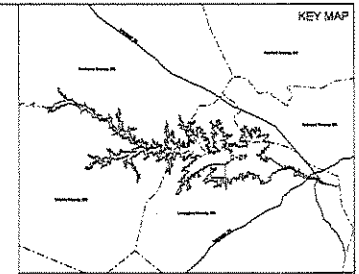
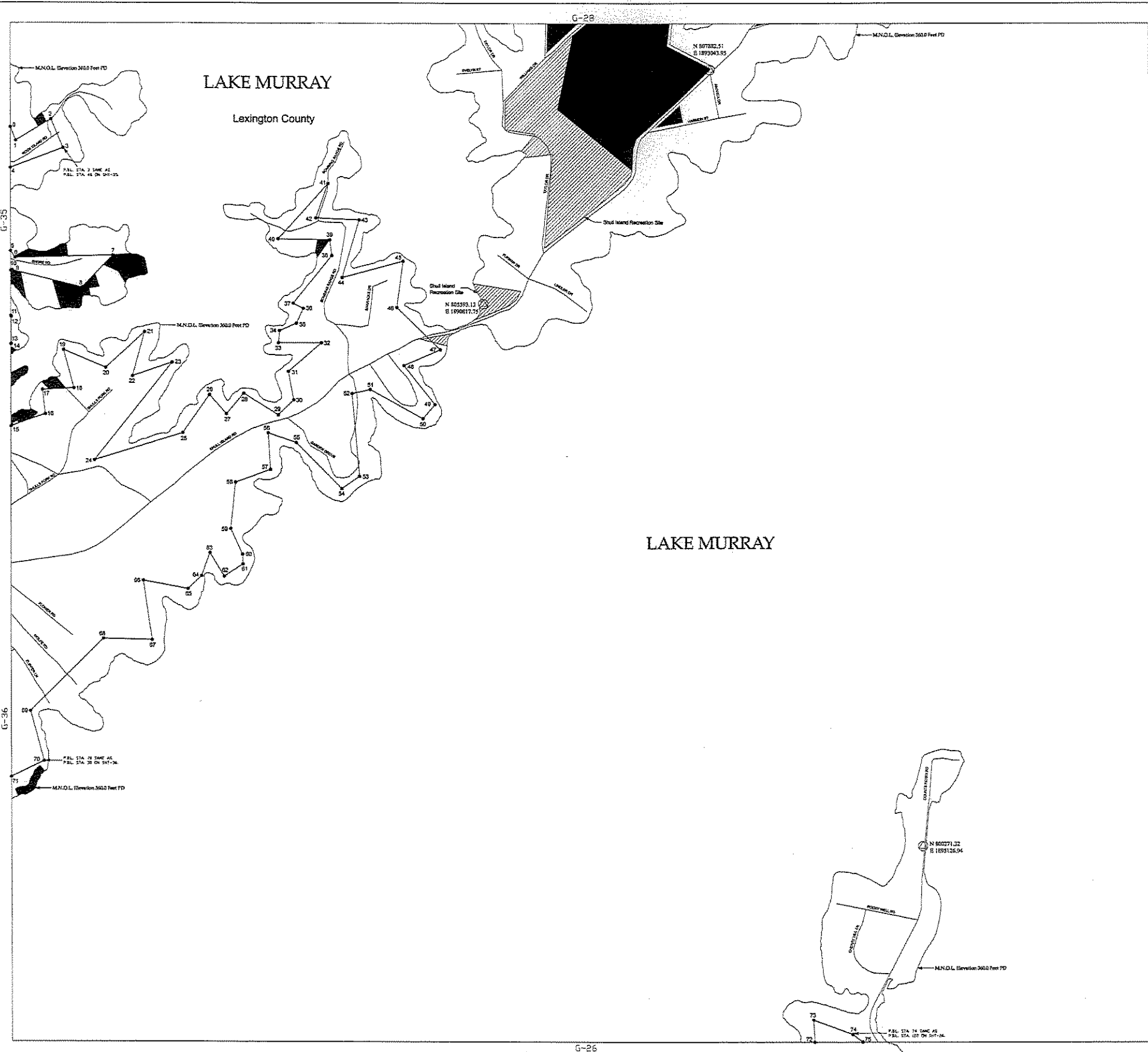

LEGEND

- Railroad
- Pipeline
- Transmission line
- Road
- Project Boundary Line
- Maximum Normal Operating Level (M.N.O.L.)
- Stream
- County boundary
- Property owned in Fee by S.C.E. & G.
- ▨ Recreation areas owned in Fee by S.C.E. & G.

HORIZONTAL DATUM BASED ON THE SOUTH CAROLINA STATE PLANE COORDINATE SYSTEM 1883/2001 (INTERNATIONAL FOOT).
 VERTICAL DATUM BASED ON NAVIGS (FEET).
 TO CONVERT FROM S.C.E. & G. PLANT DATUM (PD) TO NAVIGS (FEET) ADD -21.5'. THE PROJECT BOUNDARY LINES ARE BASED ON RECORD SURVEYS AND RECORDS OF RECORD UNLESS OTHERWISE NOTED. ALL AREAS OF THE PROJECT BOUNDARY THAT ARE ELEVATION CONTROLLED WERE PROVIDED BY S.C.E. & G. AND SURVEYED BY ORSIS, INC.

STRENGTHENING PROCEED IN ACCORDANCE WITH NATIONAL MAP ACTING STANDARDS. AERIAL PHOTOGRAPHY WAS FLOWN AT A SCALE APPROXIMATELY 1 INCH = 600 FEET.

1. GERRARD GERRARD, A PROFESSIONAL SOUTH CAROLINA PHOTOGRAMMETRIC SURVEYOR/HANDY MAN SURVEYOR HAS REVIEWED THE LAKE MURRAY PROJECT MAPS. THE PLANIMETRIC AND COMPOUND SHOWN ON SAID MAPS ARE IN ACCORDANCE WITH THE NATIONAL MAP ACTING STANDARDS FOR THE SCALE OF 1"=100' AND WERE PRODUCED USING PHOTOGRAMMETRIC METHODS UNDER MY DIRECT SUPERVISION. ALL WORK IS BASED ON 1883/2001 SOUTH CAROLINA STATE PLANE COORDINATE SYSTEM (INTERNATIONAL FOOT) AND THE VERTICAL DATUM IS NAVIGS (FEET).



2. GARY EATON, A PROFESSIONAL LAND SURVEYOR IN THE STATE OF SOUTH CAROLINA P.L.S. 13163, HAS REVIEWED THIS PORTION OF THE LAKE MURRAY PROJECT BOUNDARY SHOWN HEREIN. THE LICENSEE EITHER OWNS IN FEE SIMPLE OR POSSESSES PLANNED EASEMENTS OVER THE LANDS SHOWN ON THIS MAP THAT ARE INSIDE THE PROJECT BOUNDARY. THE PROJECT BOUNDARY LINES THAT ARE NOT SURVEYED LINES WERE BASED ON S.C.E. & G. SURVEYS AND RECORDS SURVEYS AND RECORDS OF RECORD.

EXHIBIT G SHEET G-27

DETAIL MAP OF PROJECT AREA
 SHEET 27 OF 77
 SALUDA HYDROELECTRIC PROJECT NO. 516
 SOUTH CAROLINA ELECTRIC & GAS COMPANY

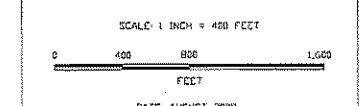

DATE: AUGUST 2008